



## **Rosslyn Street Reserve**

### Community Consultation Findings

March 2023

## 1. Introduction

This report summarises community consultation on the proposed minor upgrade of the open space at Rosslyn Street Reserve, Clovelly Park

An Open Space Plan was endorsed by Council in 2020 to provide upgrades to open spaces across Council. As part of this plan, minor open space upgrades are proposed at Rosslyn Street Reserve with:

- Drink fountain
- Shelter over picnic table
- Additional trees
- Sport goals

## 2. Consultation Program

Engagement occurred to inform community members of the concept design for Rosslyn Street Reserve and to seek their feedback on the choice of sport goal. The consultation survey was open for 3 weeks from 9 February to 3 March 2023.

The survey was made available online at [makingmarion.com.au/rosslyn-street-reserve](https://makingmarion.com.au/rosslyn-street-reserve)

Residents were informed about the survey in the following ways:

- **Letter** - A letter was delivered to all adjacent residents surrounding the reserve detailing the concept and asking for feedback on the type of goals to be installed.

NB: As the project is minor works under \$50,000 it did not require any consultation with the community as per Councils endorsed Open Space methodology. However, this engagement was undertaken to seek targeted feedback from adjacent residents who would be most impacted by the upgrade.

## 3. Consultation Overview

Residents were invited to provide feedback on the concept design for Rosslyn Street Reserve through the online survey via Making Marion, with specific attention to the type of sports goals required at the reserve.

In total, during this consultation period Council received 12 survey submissions and 1 emailed feedback.

A full summary of all responses to each survey question and relevant customer event feedback is provided within this report. Responses have been listed as worded by the respondent. For privacy reasons, respondents' details will not be included in a public report.

## 4. Consultation Findings

Overall, the concept design for Rosslyn Street Reserve received positive comments and constructive feedback. In summary:

- A total of 34 visits were recorded to the project's Making Marion web page where residents could access the concept design and survey.
- 12 responses to the survey were received.

Please see below for the results of this survey.

## 5. Summary of feedback received

The table below identifies some of the concerns and items raised regarding the open space upgrade and how the feedback will be considered when finalising the concept design.

Community Feedback	Design Response
<p>Sports Soccer / Tennis wall was the preferred sports goal.</p> <p>The second most preferred item was the junior AFL goals.</p>	<p>A soccer / tennis will be installed.</p> <p>Should budget permit, junior AFL goals will also be installed.</p>
<p>A toilet should be considered</p>	<p>A toilet has not been considered as part of this upgrade as the budget is limited.</p> <p>The provision of toilets in our open spaces is primarily based on the service levels with the Open Space and Playground Frameworks.</p> <p>Prioritisation regarding the placement of toilets is given to the following open spaces within the service hierarchy level</p> <ul style="list-style-type: none"> <li>• State level open space</li> <li>• Regional Playground sites</li> <li>• Regional Open Space</li> </ul>
<p>Will the playground be fenced?</p>	<p>There are no plans to fence the playground, but this could be considered in a further Open Space Plan.</p> <p>If the playground needs fencing because of a busy street and speeding traffic concerns, a traffic study can be carried out and measures put in place if needed.</p>
<p>Move the drink fountain to between the bin and picnic table.</p>	<p>The drink fountain has been located in close proximity to the existing water meter which provides the most cost effective location for installation. This location will also minimise trenching within tree protection zones.</p>
<p>Netball ring / basketball half court / tennis court to be considered.</p>	<p>With a limited budget, unfortunately a sport court cannot be considered but could be reflected in a future review of Council's Open Space Plan.</p>
<p>Reduce traffic speed and / or put in speed humps.</p>	<p>A traffic study will be carried out and measures put in place if needed.</p>
<p>Addition of CCTV</p>	<p>CCTV has not been considered in this upgrade.</p>
<p>Continue footpath around the whole park.</p>	<p>The footpath team in Council will consider this suggestion.</p>



More picnic tables	There is one picnic table in the reserve and 2 seats.
An additional shade at the swing	A shade sail is already in place, with mature trees close by.

### SURVEY RESULTS

#### Q1 What age groups are the children in your household?

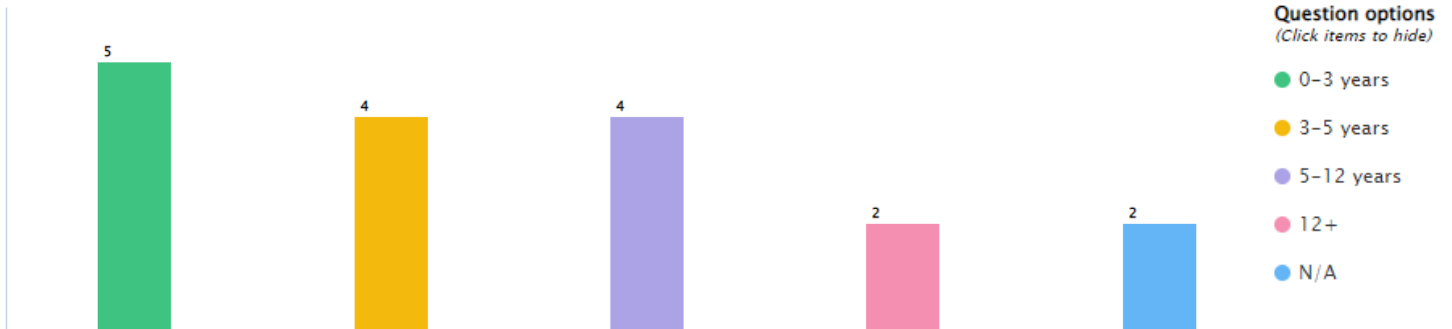

**Summary of results:** 0-12 were the dominant age groups who will use the reserve.

#### Q2 How satisfied are you with the reserve improvements?

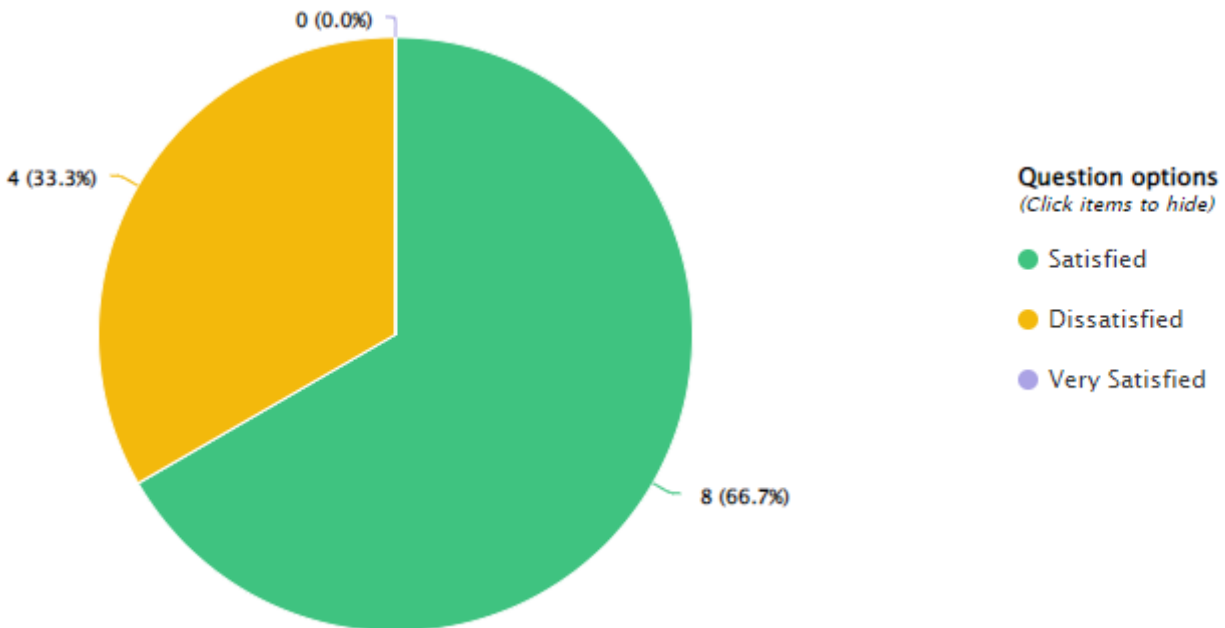

**Summary of results:** 4 residents (33.3% of respondents) were dissatisfied with the reserve improvements, with their dissatisfaction detailed in the next question.



**Q3 If dissatisfied, why?**

- There are many children that live in this area now. It is a great park attracting kids - including my own. A toilet block and bbq area is needed
- The lack of fencing around the playground worries me. It's such a busy street with traffic coming from all directions. Fencing just around the playground would make it so much safer.
- What about finding out what activities it is current used for  
The drinking fountain needs to be between the bin and picnic table

**Summary of results**  
Toilets and fencing were suggested as alternatives. However, the limited budget will not allow for these items.

**Q4. Sports Goal Options – Please tell us which option you prefer from the following?**

OPTIONS	AVG. RANK
Sports Soccer/Tennis Wall	2.10
Junior Aussie Rules goals	2.13
Sports target goal	2.33
2x Mini Soccer Goals	3.00
Soccer Dribbling Bollards	3.40

**Summary of results:** Sports Soccer / Tennis wall was the preferred option, followed by Junior Aussie Rules Goals.

**Q5. Do you have any other comments about the upgrade of Rosslyn Street Reserve?**

<p>A bike track pump type space and addition equipment would attract all children          I would prefer a basketball court over soccer          STRONG consideration need to be put in place to reduce the traffic speed to 40 or speed humps I am extremely concerned that children will be hit by a car as Beverley is used as a side way lots of traffic</p>
<p>There are children in the area who play basketball, and there isn't anywhere to practice. There are too many soccer options, and no basketball option. I would put that 1st.          There also needs to be 40km speed restrictions around the park and nearby streets. There have been incidents, where children have nearly been hit crossing the road. It isn't safe          There also needs to be CCTV, to distract the drug dealers who currently use the park as their distribution centre, as well as other adults who don't need to be in the park in the middle of the night, letting off fireworks</p>
<p>40km speed restrictions around the park and nearby streets or speed hump.          Half Basketball court, instead of what is currently there.          CCTV to distract dangerous dogs being let off the leash while kids are playing, people letting off fireworks and people hanging around the park to deal drug or something similar.</p>
<p>I'd like to see the footpath continued around the whole park, eg. Along Harcourt Ave and Rosslyn Street.          I'd also like to see some signage up for the cars/drivers along Beverley St to be aware of children around, often cars speed down this street and with the playground being on this side it is dangerous.</p>
<p>The shelter and water fountain are excellent but not sure that any of the additional structures will be well used.          Maximising the open space is the priority in my opinion.</p>
<p>I love that there is an upgrade but please add fencing. Please!!!</p>
<p>More picnic tables and fence for the playground area</p>
<p>I also wish the playground was fenced and a shade at the swing section</p>
<p>There is no need for any of the above suggestions but I can't put 5 for all items          Maybe just leave it was green open space</p>
<p>We always like to come here with my kids and friends kids. They all are 9 years old and residents of clovelly park.          They always said it's boring here nothing much to do .          it is good idea to have one tennis court, place for basketball hoop and mini soccer.          parents bbq zone/ toilet/ drinking water</p>

**Summary of results:** These comments and the design responses are included in the feedback summary.

Concern	Number of responses
Fence the playground	3
Traffic concerns	4
Sport courts – ie basketball, tennis, netball	4
CCTV	2
Footpath around the reserve	1
More picnic tables	1
No more infrastructure	2
Pump track	1

### Q7. Age Range

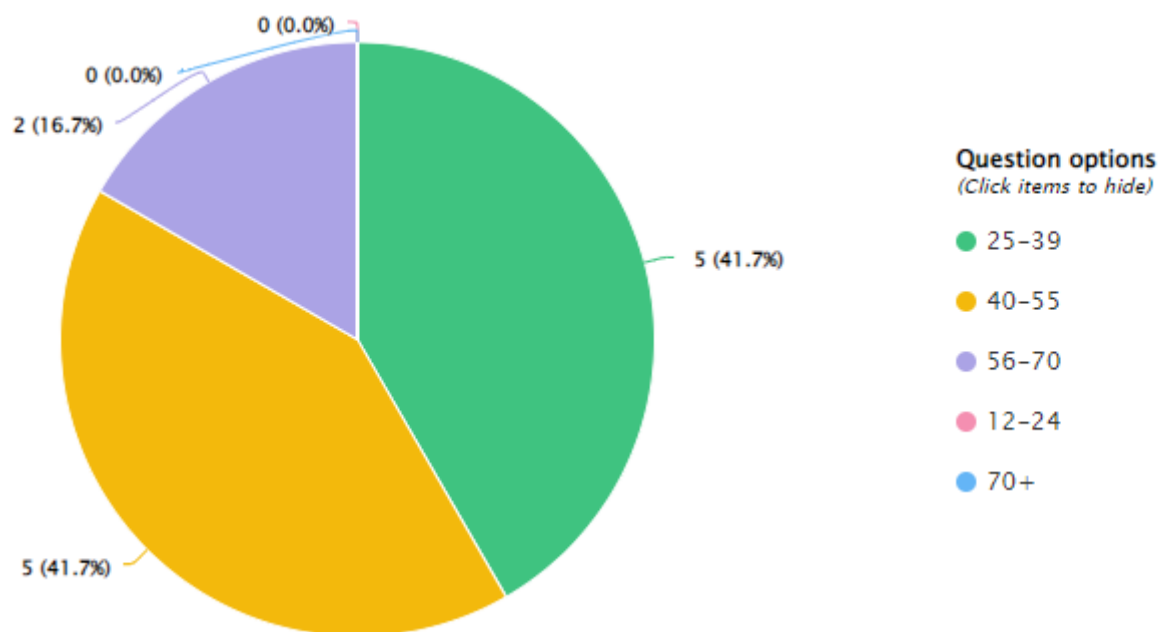

**Summary of results:** There is a variety of age ranges of respondents.

### Q8. Street name

Street name	Number of respondents
Beverley Street	2
Harcourt Avenue	3
Rosslyn Street	1
Norrie Avenue	2
Hendon Street	3
Glandore Avenue	1

All respondents lived in Clovelly Park.

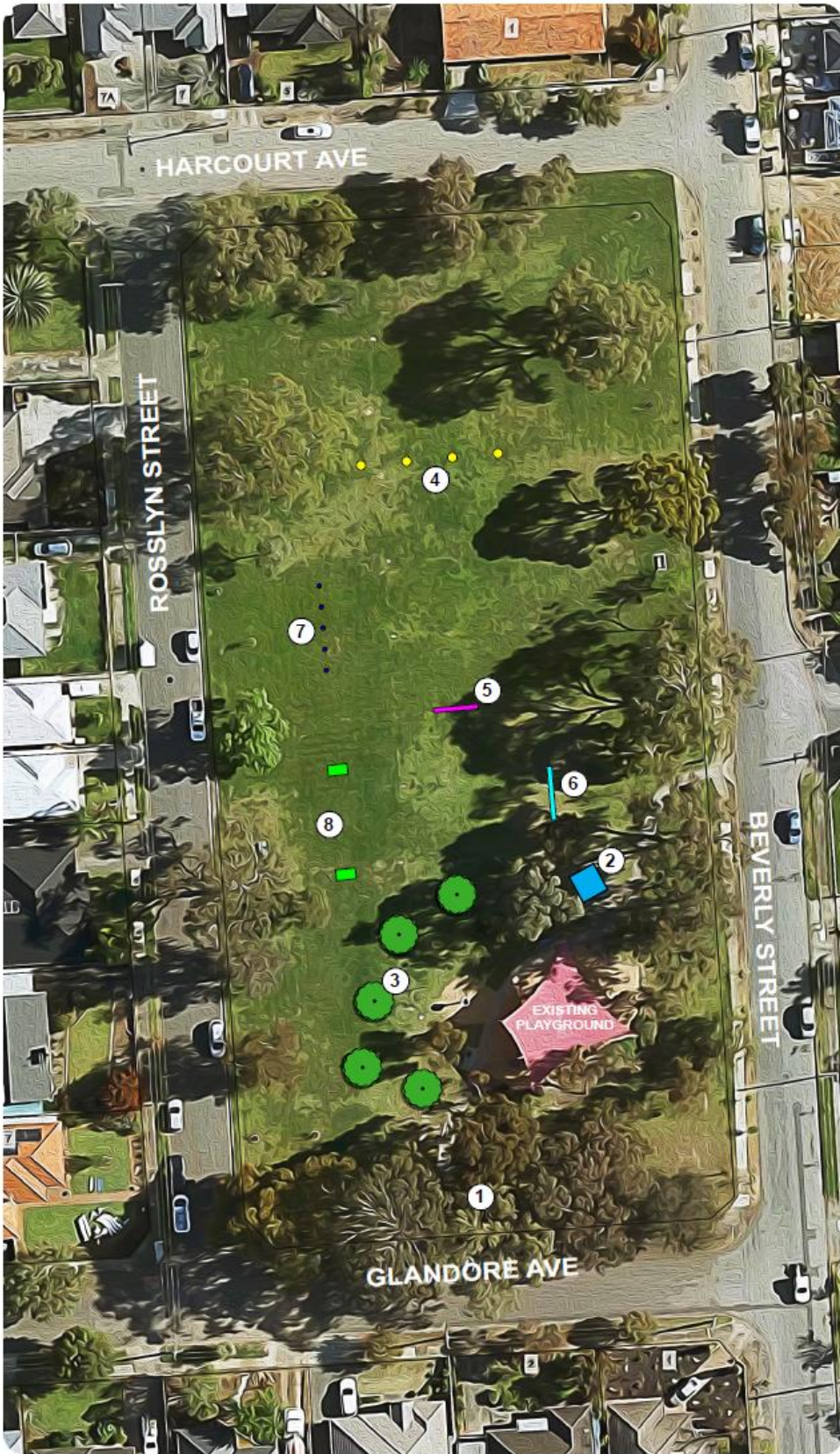

Councils Open Space Plan has included minor improvements at Rosslyn Street Reserve. This will include the following items:

- ① Proposed drink fountain with bottle refill & dog bowl. Located adjacent existing path.
- ② 4 x 4m Shelter over existing picnic table
- ③ New Tree Planting. Final location to be confirmed onsite.



Council also has funding to install sporting goals at this location. Please tell us which option you prefer from the following:

- ④ Junior Aussie Rules Goals  
Or
- ⑤ Sports target goal.  
Or
- ⑥ Sports Soccer / Tennis wall.  
Or
- ⑦ Soccer dribbling bollards.  
Or
- ⑧ 2x Mini Soccer Goals



## ROSSLYN STREET RESERVE, CLOVELLY PARK CONCEPT PLAN

@CityofMarion 
 @CityofMarion 
 City of Marion

Concept design is for illustrative purposes only. Council retains the right to modify the design in consideration of unknown site conditions, cost management and internal approvals.

