

## BMX Pump Track Majors Road

<b>Originating Officer</b>	Acting Manager City Activation - Carla Zub
<b>Corporate Manager</b>	Manager City Activation - Greg Salmon
<b>General Manager</b>	General Manager City Development - Ilia Houridis
<b>Report Reference</b>	GC210209F07

### Confidential



### Confidential Motion

That pursuant to Section 90(2) and (3)(b)(i) and (ii) of the Local Government Act 1999, the Council orders that all persons present, with the exception of the following persons: Chief Executive Officer, General Manager City Development, General Manager Corporate Services, General Manager City Services, Manager Corporate Governance, Manager City Activation, Project Manager Strategic Projects, Unit Manager Communications, Unit Manager Governance and Council Support and Governance Officer, be excluded from the meeting as the Council receives and considers information relating to the Pump Track Majors Road, upon the basis that the Council is satisfied that the requirement for the meeting to be conducted in a place open to the public has been outweighed by the need to keep consideration of the matter confidential given the information relates to proposed project funding.

### REPORT OBJECTIVE

The purpose of this report is for Council to consider bringing forward the delivery of a pump track at the Sam Willoughby BMX facility, Majors Road, O'Halloran Hill for community recreational use.

### EXECUTIVE SUMMARY

With the Sam Willoughby BMX (SWBMX) facility about to commence construction, there is an opportunity for Council to consider the delivery of the pump track at the Majors Road site.

Throughout the design of the SWBMX track, there has always been the provision made for the pump track to be located at the site in the future. The cost to deliver the pump track is up to \$136,000 and could potentially be funded from the SWBMX and Southern Soccer Facility contingency.

Should Council approve delivery of the pump track, it could be delivered by March 2022 following the completion of the SWBMX Facility. Location of pump track is the site compound of the builders for the SWBMX Facility with construction of the pump track not able to commence until the builders have left the site, which is scheduled for November 2021. Furthermore as the pump track build will involve community participation it is best timed to commence after the main build for safety reasons.

This report considers the opportunity for the delivery of the pump track at Majors Road to provide a community recreational facility and complete the vision for the SWBMX Facility.

### RECOMMENDATION

**That Council:**

1. **Notes the estimated cost of the pump track is \$136,000.**
2. **Requests Administration to proceed with detailed design and delivery of the pump track at the SWBMX Facility with expenditure of up to \$136,000 from the SWBMX project contingency in the first instance, with any balance from the Asset and Sustainability Reserve.**

**OR**

1. **Notes the estimated cost of the pump track is \$136,000 and elects not to proceed with the delivery of the pump track.**
2. **In accordance with Section 91(7) and (9) of the Local Government Act 1999, orders that this report, the attachments to this report and any minutes arising from this report, having been considered in confidence under Section 90 (2) and (3)(b)(i)(ii) of the Act, except when required to effect or comply with Council's resolution(s) regarding this matter, be kept confidential and not available for public inspection for a period of 12 months from the date of this meeting. This confidentiality order will be reviewed at the General Council Meeting in December 2021.**

## **GENERAL ANALYSIS**

From the commencement of design for the Sam Willoughby BMX Facility, the vision was for the site to house a UCI accredited BMX track for the elite and club riders with a pump track available for community recreational use. The location for the pump track has been identified on the site between the car park and Majors Road (refer to Attachment One).

The pump track is not in the current scope for the project so there is no design or planning approval for this element.

Through recent discussions with DEW who have expressed an interest to increase community use at the venue, assessment of the BMX track and benchmarking with other like venues, indicate that it would be too risky for non BMX riders. Similar BMX tracks around Australia such as Sleeman and Bathurst with 5m and 8 start hills are closed to the public due to safety risk and cost of insurance. This is applicable for the SWBMX track. The pump track would address this concern.

With the SWBMX project about to commence construction, there is an opportunity for Council to deliver the pump track.

Indicative cost to deliver the track would be up to \$136,000 which would include design, construction of the track and landscaping (as well as preliminaries and contingencies). Estimates are based on the cost of tracks recently constructed in SA:

- \$135,594 - Initial cost estimate at SWBMX site
- Cost of other pump tracks \$150,000 Mount Gambier (comparable), \$100,000 Goolwa and \$50,000 Tangari.

The delivery of the pump track will need to consider site issues, landscaping and integration of the track into the site, reactive soils, constructing on the hills face zone, design and contingencies that must also be allowed for.

The delivery of the pump track presents an opportunity for the community and the clubs to be involved in the construction of track (dig days and shaping), which have been models that City of Onkaparinga and Adelaide City Councils have used, and have aided to reduce costs.

## **Funding**

The estimated cost to design and deliver the pump track is \$136,000. Council can consider funding the pump track from the SWBMX project contingency in the first instance with any additional funds coming from the asset sustainability reserve. This cost may reduce with an opportunity for the community to be involved in the build.

### Pump Track Time Frames

Should funding become available, the time frame to design and deliver the pump track would be as follows:

	Time Frame
Design, consultation and planning approval	9 months
Delivery of the Track and landscaping	3 months by March 2022

As the pump track is to be delivered in the location of the SWBMX construction site compound, the builder will need to complete their construction works and decommission their site compound before construction of the pump track can commence. The pump track will include an opportunity for community participation in the build and therefore it is safer to construct it after the main build is complete.

### Consultation

To date no community engagement has been undertaken on a pump other than previous engagement with the Clubs. The next steps would be to engage a design consultant and undertake a consultation process with clubs and community.

### Attachment

#	Attachment	Type
1	SWBMX Facility with Pump Track	PDF File

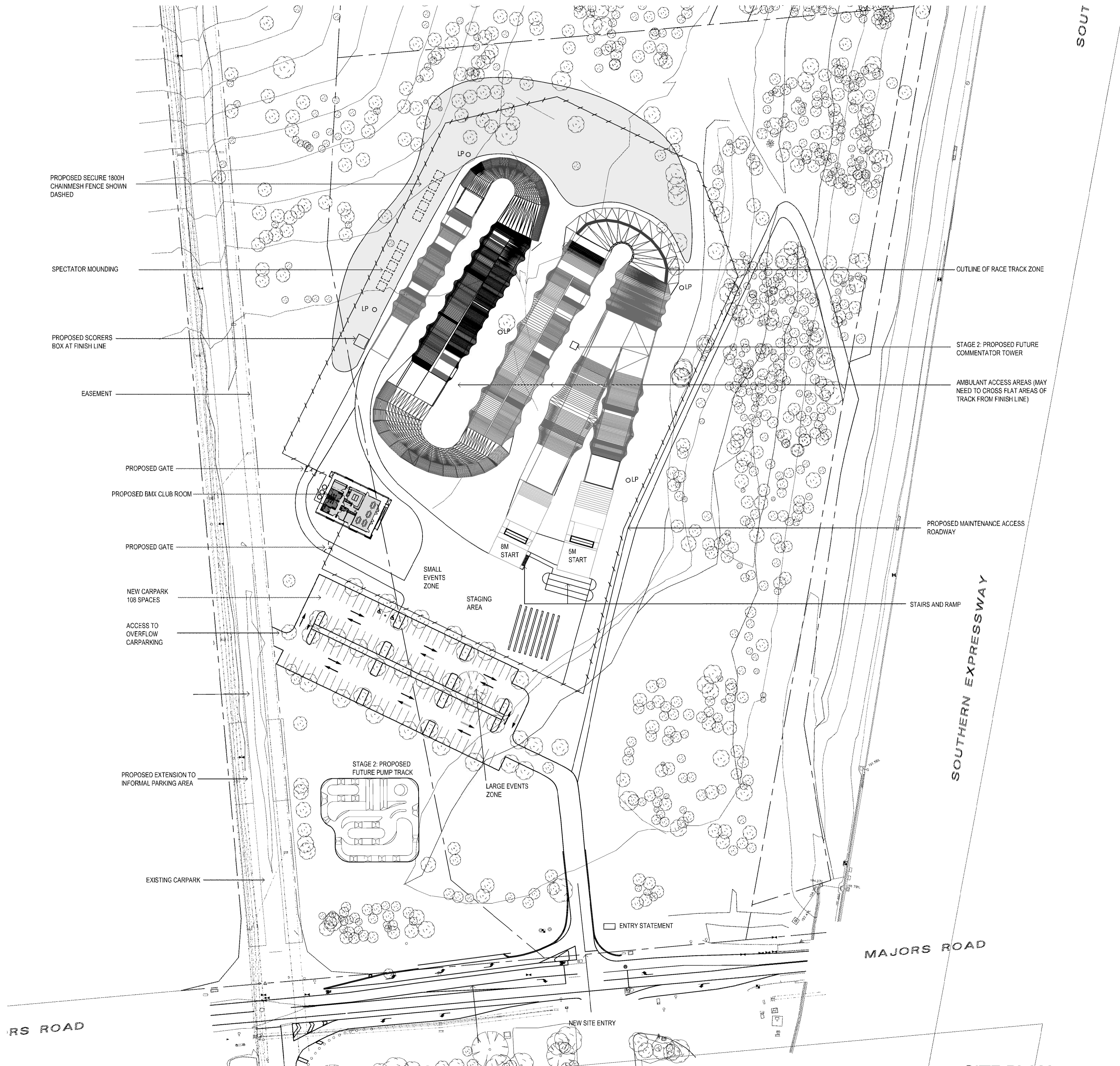

LEGEND:

- SPECTATOR TENTS
- PROPOSED SECURE 1800H CHAINMESH FENCE SHOWN DASHED
- SPECTATOR MOUNDING - SALVAGED SOIL REUSED TO CREATE SPECTATOR VIEWING AND WIND BREAK MOUNDING. FINAL EXTENT AND HEIGHT TO BE DETERMINED.
- 15m LIGHT TOWER
- STAGE 2: PROPOSED FUTURE COMMENTATOR TOWER

